

SAINT-GOBAIN

Gyproc® Fibre Cement Board



GYPROC® FIBRE CEMENT BOARD

GYPROC® FIBRE CEMENT BOARD is an autoclaved cellulose fibre cement flat board. It is 100% asbestos-free board with a smooth surface and a square edge.

It is tough and flexible, an ideal choice for many general building purposes including ceiling and wall partitioning, both internally and externally. It can also be used for gable end, facades, eave lining, permanent formwork and substrate flooring.

ADVANTEGES

- Tough & Flexible
- Durable
- Dimensionally stable
- Smooth surface
- Fire resistant
- Termite proof
- Non-hazardous to health - 100% asbestos-free
- Versatile In application
- Can be used in exterior applications
- Rapid Installation
- Suitable for all types of finishes
- Virtually maintenance-free

GENERAL PRODUCT INFORMATION

Product Characteristics

Basic Competition

Portland cement, refined sand and cellulose fibre

TECHNICAL PROPERTIES

Gyproc Fibre Cement Board is as per IS-14862:2000, Type B, Category '3'

Properties	Unit	Performance
Apparent Density	Kg/m ³	> 1250
Standard Weight (for 6.0 mm)	Kg/m ²	7.5
Thermal Conductivity (50° C mean temperature)	W/m.K	0.21
Linear Coefficient of Thermal Expansion	Per ° C	7.5×10^{-6}
pH Value		12
Acoustic Insulation	Rw dB	51Rw dB for 92 mm system

Dimensions Available

Thickness mm	Size mm x mm	Edge type
4.0	595 x 595 595 x 1195 1220 x 1220	S/E
6.0	595 x 595 595 x 1195 1220 x 2440	S/E
8.0	1220 x 2440	S/E
10.0	1220 x 2440	S/E
12.0	1220 x 2440	S/E

* Other thickness also available based on order size

HANDLING AND STORAGE

Boards should be stocked flat on level surface with sufficient support such as on pallet/frame or on timber blocks as shown in diagram (I). Do not stock boards with Insufficient support as shown In diagram (II).

To ensure optimum performance, store boards undercover and keep dry prior to fixing. If the boards become wet, allow drying before fixing is commenced.

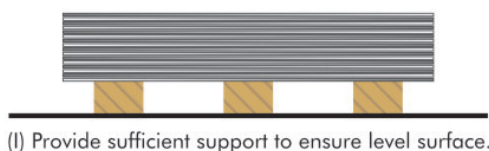

(I) Provide sufficient support to ensure level surface.



(II) Do not stack with insufficient support.

CEILING INSTALLATION

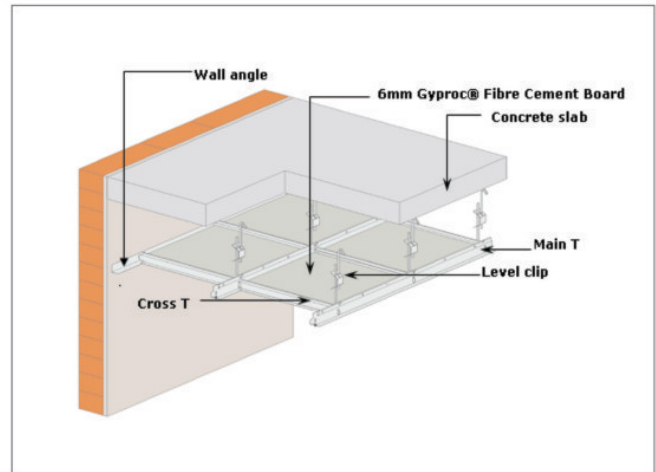

PARTITION INSTALLATION

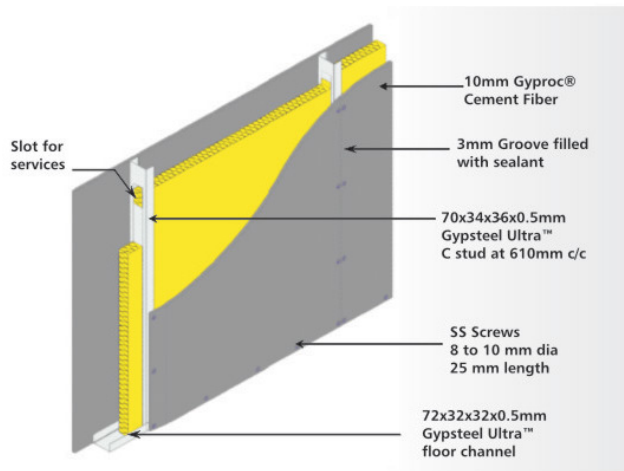

WALL LINING SYSTEM

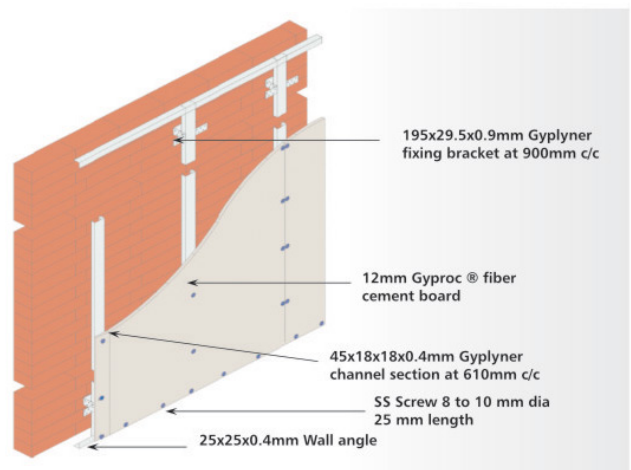

Painting

For excellent results, Gyproc® Fibre Cement Boards can be painted with water-based acrylic paints. In all cases, reference should be made to the paint manufacturer's Instructions. For further Information on other applications, please consult our technical sales personnel.

The Saint-Gobain group founded in 1665, is one of the world's 100 largest industrial groups and the world no. 1 in building materials. It operates in four core sectors – Building Distribution, Innovative Materials, Packaging and Construction Products. Saint-Gobain operates in over 64 countries worldwide and fields a workforce in excess of 190,000. Saint-Gobain is a world leader in each of its competencies. The future strategy of Saint-Gobain is focused on attaining “worldwide leadership in construction markets, offering innovative solutions to meet the fundamental global challenges of growth, energy and environment”.

Saint-Gobain Gyproc India Ltd. is a market leader in the interior construction space in India for well over 2 decades. The ever expanding product range includes gypsum plasterboard systems for false ceiling & drywall applications, ceiling tiles (gypsum, mineral fibre tiles, glass wool) for grid ceiling applications, gypsum plasters for internal wall finishes plus a complete range of accessory products.

The entire gypsum plaster board, ceiling tiles and gypsum plaster range of products are approved by CII - IGBC for consideration towards Green Building rating systems (LEED) points.



The contents of this manual are covered by copyright laws. Reproduction of all or any part without the owner's permission is prohibited. All illustrations are subject to change. Whilst every care has been taken in the preparation of this product guide, Saint-Gobain Gyproc India Ltd. expressly disclaims all and any liability to any person whether a purchaser of any product details of which are set out in this product manual, or otherwise in respect of anything done or omitted to be done and the consequences of anything done or omitted to be done, by any such person in reliance, whether in whole or in part upon the whole or part of the within information.

Corporate Office: Saint-Gobain Gyproc India Limited. 5th Level, Leela Business Park,
Andheri Kurla Road, Andheri (East), Mumbai - 400 059. Tel.: +91 22 4021 2121, Fax : +91 22 4021 2392

Branch Offices :

Ahmedabad : Tel.: (079) 66052564 / 65
Bengaluru : Tel.: (080) 41213131, 41518107
Chandigarh : Tel.: (0172) 5085168
Chennai : Tel.: (044) 26211260 / 261
Coimbatore : Tel.: (0422) 4374830
Delhi NCR : Tel.: (0120) 4061800
E-mail : gyprocindia@saint-gobain.com

Hyderabad : Tel.: (040) 66626858
Jaipur : Tel.: (0141) 4006308
Kolkata : Tel.: (033) 22891241, 22891242
Kochi : Tel.: (0484) 2544409
Lucknow : Tel.: (0522) 2618727
Pune : Tel.: (020) 26431702, 26436851
Website : www.saint-gobaingyproc.in